

* THESE COMPONENTS ARE LOCATED IN THE FLUID CYLINDER GROUP, ITEM ②
 ** THESE COMPONENTS ARE LOCATED IN THE STUFFING BOX GROUP, ITEM ③
 *** THESE COMPONENTS ARE LOCATED IN THE ATTACHING GROUP, ITEM ⑧

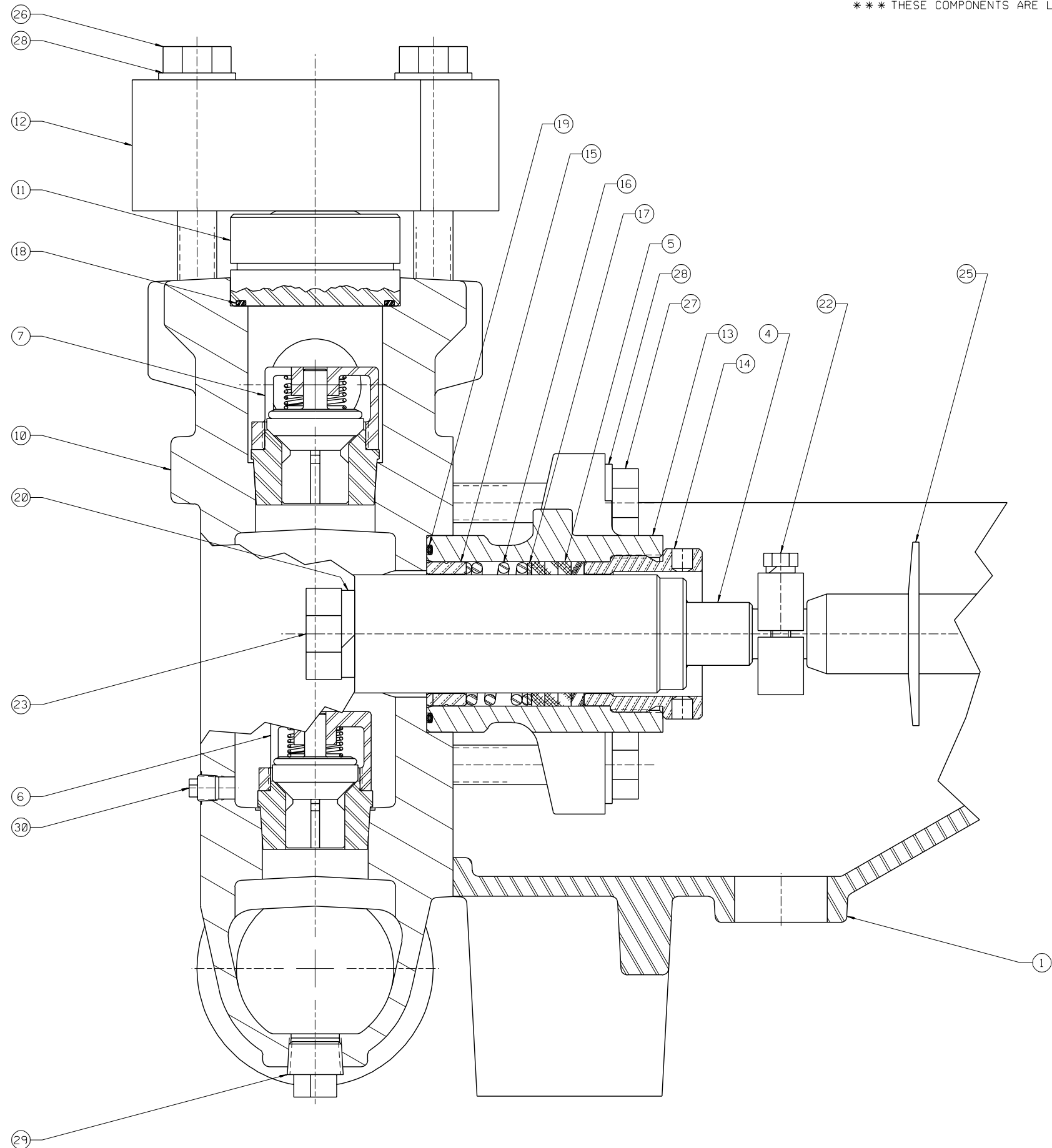

ITEM	NO. RECD	PART NO.	PART NAME
①	1	5267536	POWER END ASSEMBLY:
②	1	5274031	FLUID CYLINDER GROUP:
③	3	3266936	STUFFING BOX GROUP:
④	3	5277709	PLUNGER: 2¼" DIA, COLMONOY
⑤	3	5277726	PACKING SET:
⑥	3	5273331	VALVE ASSEMBLY: AR, SUCTION
⑦	3	5273330	VALVE ASSEMBLY: AR, DISCHARGE
⑧	1	3267445	ATTACHING GROUP:
⑨	1	5273354	LIT KIT:
* ⑩	1	5273340	FLUID CYLINDER:
* ⑪	3	5264371	VALVE COVER:
* ⑫	3	5262885	VALVE COVER CLAMP:
** ⑬	3	5273336	STUFFING BOX:
** ⑭	3	5275014	ADJUSTING NUT:
** ⑮	3	5275010	THROAT BUSHING/FOLLOWER:
** ⑯	3	5277725	PACKING SPRING:
** ⑰	3	5275056	COMPRESSOR RING:
** ⑱	3	320942	O-RING: 2⅞" OD X ⅛" NOM., TEFLON
** ⑲	3	320944	O-RING: 3⅞" OD X ⅛" NOM., TEFLON
*** ⑳	2	1100249	LOCK WASHER: 1"
*** ㉑	2	1113543	DOWEL PIN: ¾" DIA X 2" LG.(NOT SHOWN)
*** ㉒	3	1252143	CLAMP ASSEMBLY:
*** ㉓	2	320988	HEX HD. CAP SCREW: 1-8 X 3½" LG.
*** ㉔	1	5267123	LIQUID LEVEL GAGE:(NOT SHOWN)
*** ㉕	3	5262851	SHIELD DEFLECTOR:
*** ㉖	6	111649	HEX HD. CAP SCREW: ¾-10 X 5" LG.
*** ㉗	6	110785	HEX HD. CAP SCREW: ¾-10 X 4" LG.
*** ㉘	12	1107387	FLAT WASHER: ¾"
*** ㉙	3	1105060	PLUG: ¾" PIPE
*** ㉚	3	1109973	PLUG: ⅝" PIPE
*** ㉛	2	1177203	CAPLUG: INT. 20S (NOT SHOWN)
*** ㉜	2	1120444	CAPLUG: INT. 50I (NOT SHOWN)

NOTES:

- TORQUE FASTENERS PER FMC ENGR SPEC AS-22
- TEST PUMP PER FMC ENGR SPEC AS-15
- STAMP NAMEPLATE WITH FOLLOWING DATA IN THE "MAX CONDITIONS" SPACES;

POWER	117 HP
DISCH. PRESS.	2000 PSI
FLOW RATE	90 GPM
SPEED	580 RPM

- PAINT PUMP PER FMC ENGR SPEC CP-20
- USE KIT P504319 FOR VALVE REPAIR

This drawing is the property of FMC Corporation, and may not be used, reproduced, published, or disclosed to others, without express authorization FMC Corp.		FMC Corporation Fluid Control Division 2825 W. Washington Box 1377 Stephenville, Texas 76481	
Unless Otherwise Specified: Remove all burrs & sharp corners .005 R. All diameters concentric unless .001 I.D.C.		PUMP ASSEMBLY M1218DI SC, W/3" NPT X 1½" NPT FLUID END, COLMONOY PLUNGER, TEF/KEV PACKING & AR VALVE ASSEMBLIES	
RELEASED FOR PRODUCTION	DATE	SCALE	NONE
ECN	DATE	SIZE	DRAWING NO.
REV	WAS	APPD.	RMc
06-18-98	06-11-98	05-22-98	05-26-98
5273352		5273352	

F	REV & REDRAWN	500634	SJK	04-20-01
REV	WAS	ECN	BY	DATE

5273352